

HALOSTAR Standard

Low-voltage halogen lamps with pin base



- General illumination
- Kitchen lighting
- Mirror lighting
- Lighting for reading
- Entrance lighting
- Shops
- Restaurants, hotels and similar prestigious applications
- Offices, public buildings

Product benefits

- Brilliant accent light
- Incredibly small dimensions for revolutionary new luminaire designs
- Approved for use in open luminaires (to IEC 60598-1)
- UV filter
- Contains no mercury, can be thrown away with normal household waste

Product features

- Average life: 2,000 h
- 100 % dimmable
- Color rendering index R_a : 100
- Base: G4, GY6.35



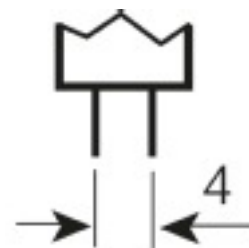
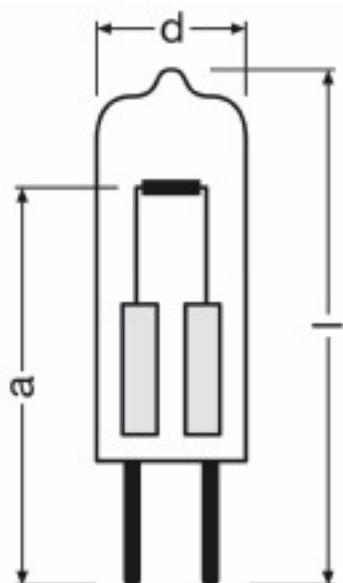

G4
IEC 7004-72
DIN 49757

Fassungsnorm:
IEC 7005-72

Product line drawing with letters

10 W 12 V G4 | 20 W 12 V G4 | 35 W 12 V GY6.35 | 50 W 12 V GY6.35

Base

10 W 12 V G4 | 20 W 12 V G4

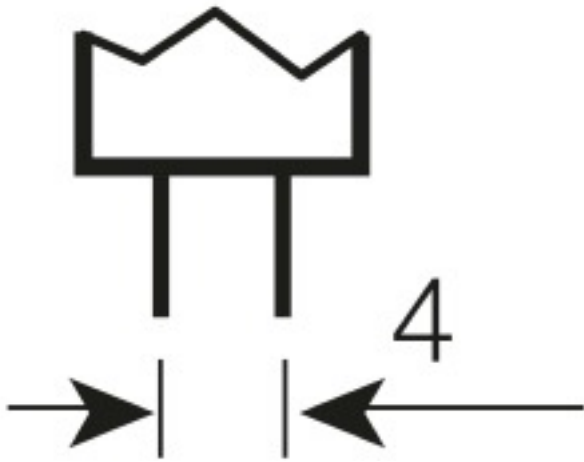

Base
10 W 12 V G4 | 20 W 12 V G4

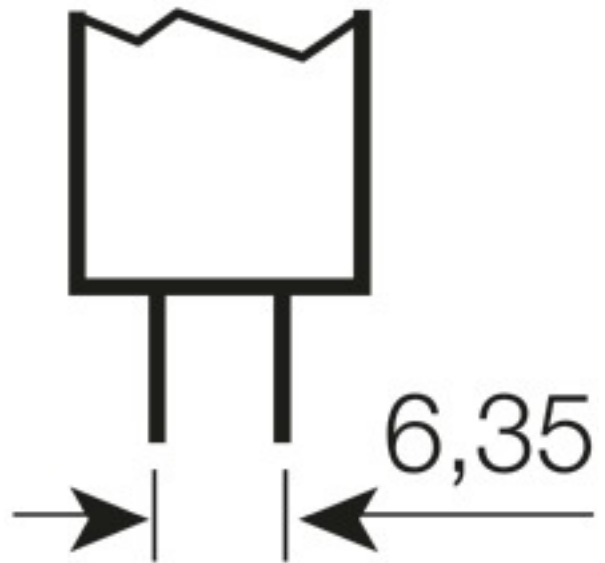

Base
35 W 12 V GY6.35 | 50 W 12 V GY6.35

Technical data

Product description	Nominal luminous flux	Rated luminous flux	Base (standard designation)	Rated wattage	Nominal wattage	Nominal voltage
10 W 12 V G4	140 lm	140 lm	G4	10 W	10 W	12 V
20 W 12 V G4	260 lm	320 lm	G4	20 W	20 W	12 V
35 W 12 V GY6.35	600 lm	600 lm	GY6.35	35 W	35 W	12 V
50 W 12 V GY6.35	720 lm	720 lm	GY6.35	50 W	50 W	12 V

Product description	Nominal voltage	Nominal lamp life time	Rated lamp life time	Rated color temperature	Rated color rendering index Ra	Rated starting time
10 W 12 V G4	12 V	2000 h	2000 h	2800 K	100	0.0 s
20 W 12 V G4	12 V	2000 h	2000 h	2800 K	100	0.0 s
35 W 12 V GY6.35	12 V	2000 h	2000 h	2900 K	100	0.0 s
50 W 12 V GY6.35	12 V	2000 h	2000 h	3000 K	100	0.0 s

Product description	Rated starting time	Rated warm-up time (60 %)	Rated number of switching cycles	Rated lamp mercury content	Rated power factor λ	Overall length
10 W 12 V G4	0.0 s	0 s	1000000 ¹⁾	0.0 mg	1.00	33.0 mm
20 W 12 V G4	0.0 s	0 s	1000000 ¹⁾	0.0 mg	1.00	33.0 mm
35 W 12 V GY6.35	0.0 s	0 s	1000000 ¹⁾	0.0 mg	1.00	44.0 mm
50 W 12 V GY6.35	0.0 s	0 s	1000000 ¹⁾	0.0 mg	1.00	44.0 mm

Product description	Overall length	Diameter	Dimmable	Burning position	ILCOS	Light center length (LCL)
10 W 12 V G4	33.0 mm	10.0 mm	Yes	Any	HSGST/C/UB-10-12-G4-10/22	22.0 mm
20 W 12 V G4	33.0 mm	10.0 mm	Yes	Any	HSGST/C/UB-20-12-G4-10/22	22.0 mm
35 W 12 V GY6.35	44.0 mm	12.0 mm	Yes	Any	HSGST/C/UB-35-12-GY6,35-12/30	30.0 mm
50 W 12 V GY6.35	44.0 mm	12.0 mm	Yes	Any	HSGST/C/UB-50-12-GY6,35-12/30	30.0 mm

¹⁾ At 1 s on / 1 s off

Application advice

For more detailed application information and graphics please see product datasheet.

Disclaimer

Subject to change without notice. Errors and omission excepted. Always make sure to use the most recent release.